

Peaks & Ridges candidate no. 157
General Location Abington Rd. & Crystal Valley Ct.
Parcel Numbers 214180060 etc.

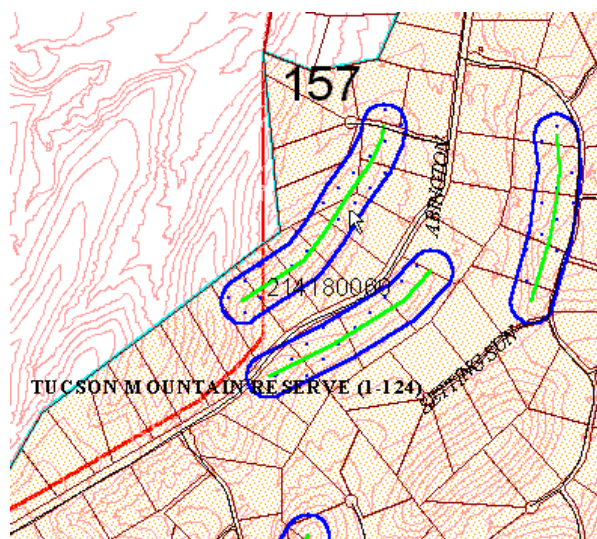

Photo facing southwest from Abington Rd.



Score by criteria:

1. The peak or ridge lies within one mile of a public preserve- **Yes.**
2. The peak or ridge is within 150 feet of land subject to BOZO- **Yes.**
3. The peak or ridge is a dominant feature in the surrounding landscape or constitutes a significant linking element of such geographic feature- **No.**
4. The peak or ridge is an extension of a mountain, major hill or ridge, or other significant terrain feature, from a designated public preserve- **Yes.**
5. The peak or ridge's silhouette is visible from a scenic route, major street, public vista point, or a major community viewpoint- **Yes.**
6. The land form is in a subdivision recorded prior to October 30, 2002 **Yes.**
7. The land form encompasses a substantial portion of an undeveloped lot- **Yes.**
8. Should the county consider acquiring the property if the protected area may create an unbuildable lot? **Unlikely.**

Staff Recommendation: Staff recommends **NO** protection for this peak/ridge. This feature is a neighborhood hill. The silhouette is only prominent at the most local level. The entire ridge line is within a recorded subdivision, Tucson Mountain Preserve. The protected area would impact access and development within several plated lots.

Commission Recommendation: The Commission recommended **NO PROTECTION.**

