

Peaks & Ridges candidate no. 98  
General Location Lazy C Circle west of Camino De Oeste  
Parcel Numbers 214470450 etc.

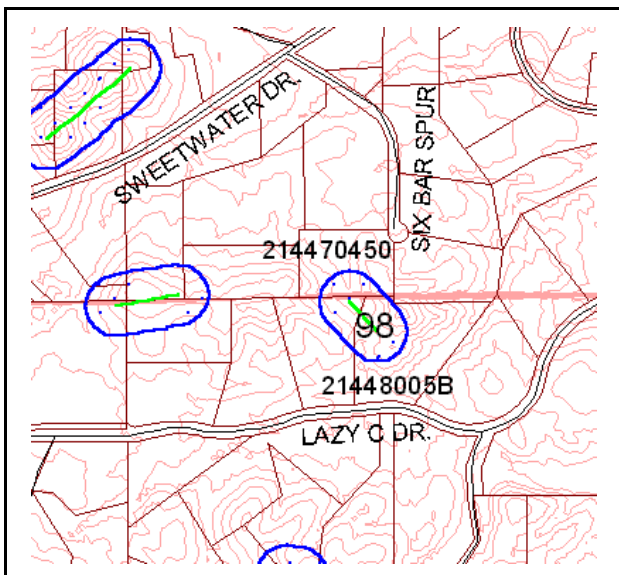

Photo facing northwest from Lazy C Circle



**Score by criteria:**

1. The peak or ridge lies within one mile of a public preserve-**Yes**
2. The peak or ridge is within 150 feet of land subject to BOZO-**Yes**
3. The peak or ridge is a dominant feature in the surrounding landscape or constitutes a significant linking element of such geographic feature-**No**
4. The peak or ridge is an extension of a mountain, major hill or ridge, or other significant terrain feature, from a designated public preserve-**No**
5. The peak or ridge's silhouette is visible from a scenic route, major street, public vista point, or a major community viewpoint-**No**
6. The land form is in a subdivision recorded prior to October 30, 2002-**No**
7. The land form encompasses a substantial portion of an undeveloped lot-**No**
8. Should the county consider acquiring the property if the protected area may create an unbuildable lot? **Unlikely**

**Staff Recommendation:** Staff recommends **Level 2** protection for this peak/ridge. This hill has some prominence at the neighborhood level but not when evaluated from a community level. The feature is visible from Sweetwater Drive, a scenic route, but does not merit the protected peak designation. The protected area encompasses portions of three lots.

**Commission Recommendation:** The Commission Recommended **LEVEL 2 PROTECTION**.